

VCR

BI & AF - Arrangement 3, DWDI, Class I & II

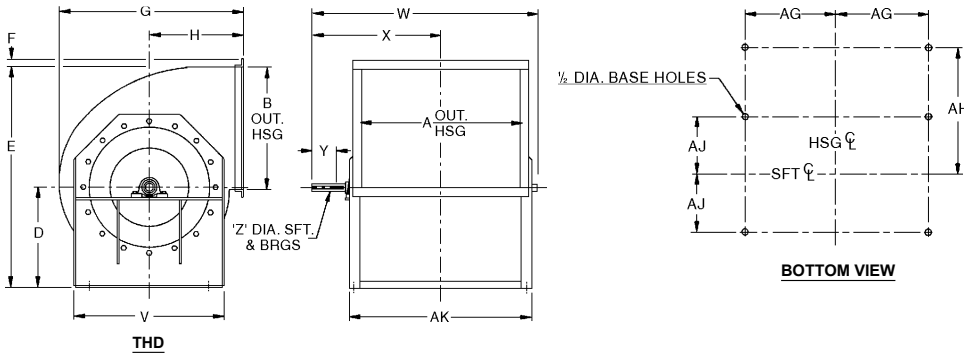

Notes

1. CW rotation shown; CCW rotation similar but opposite.
2. AF available in sizes 182 through 270.
3. BI available in sizes 122 through 170.
4. Discharge angles standard on sizes 122 thru 270 only. (Hole punching optional on all sizes.)
5. On specific sales orders, see Fan Data Schedule for performance and accessory information.

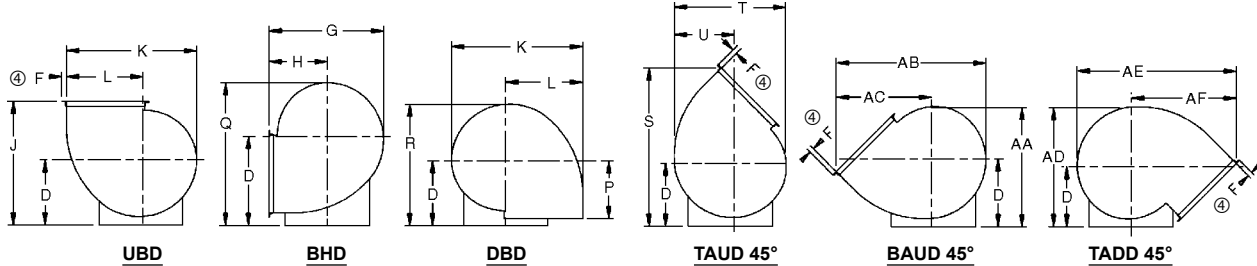

Dimensional Data

Size	A	B	"D" Centerline of Fan							E	F	G	H	J	K	L	M	N	P	Q	R	S	T
			THD	UBD	BHD	DBD	TAUD	BAUD	TADD														
122	17 1/2	13	11 1/2	11 1/2	15	11 1/2	11 1/2	15	15	24 7/16	1 1/4	20 13/16	10 1/4	21 3/4	22 1/4	12 15/16	—	—	10 1/4	24 5/16	22 1/16	27 15/16	19 7/8
135	19 3/8	14 5/16	12 3/4	12 3/4	16 1/4	12 3/4	12 3/4	16 1/4	16 1/4	27	1 1/4	22 7/8	11 1/4	24	24 1/2	14 1/4	—	—	11 1/4	26 1/2	24 3/8	30 3/4	21 7/8
150	21 1/4	15 7/8	12 3/4	14	18	12 3/4	14	18	18	28 9/16	1 1/4	25 7/16	12 1/2	26 1/2	27 1/4	15 13/16	—	—	12 1/2	29 7/16	25 11/16	34	24 5/16
165	23 5/8	17 3/8	14	15 1/4	19 1/2	14	15 1/4	19 1/2	19 1/2	31 5/16	1 1/4	28	13 3/4	29	29 7/8	17 5/16	—	—	13 3/4	32 1/16	28 1/4	37 1/4	26 3/4
182	25 13/16	19 3/8	15	17	21 1/2	15	17	21 1/2	21 1/2	34 5/16	1 1/4	30 3/16	14 1/2	31 1/2	33 1/8	19 5/16	—	—	14 1/2	35 5/16	30 11/16	40 15/16	29 5/8
200	28 11/16	21 1/4	16 1/4	20	23 1/2	16 1/4	20	20	20	37 7/16	1 1/4	32 7/8	15 5/8	35 5/8	36 3/8	21 3/16	—	—	15 5/8	38 11/16	33 1/2	46 1/16	32 1/2
222	31 3/8	23 5/8	18	20 1/2	26	18	20 1/2	26	20 1/2	41 9/16	1 1/4	36 5/8	17 1/2	38	40 7/16	23 9/16	—	—	17 1/2	42 7/8	37 1/8	49 1/2	36
245	34 7/8	25 15/16	20	22 1/2	28	20	22 1/2	28	22 1/2	45 7/8	1 1/4	40 5/16	19 1/4	41 3/4	44 7/16	25 7/8	—	—	19 1/4	46 9/16	41 1/16	54 1/2	39 3/4
270	38 5/16	28 5/8	22	24 3/4	31	22	24 3/4	31	24 3/4	50 9/16	1 1/4	44 5/16	21 1/8	45 7/8	49	28 9/16	—	—	21 1/8	51 7/16	45 3/16	60 3/4	43 3/4

Size	U	V	CLASS I		CLASS II		Y	Z - CLASS I			Z - CLASS II			AA	AB	AC	AD	AE	AF	AG	AH	AJ	AK
			W	X	W	X		SFT	DR. EXT.	KWY	SFT	DR. EXT.	KWY										
122	11 3/16	16	26 1/2	15 3/8	28 5/8	16 5/8	3	1 3/16	1 3/16	1/4 x 1/8	1 7/16	1 7/16	3/8 x 3/16	23 11/16	26 3/8	16 7/16	26 3/16	31 11/16	21 3/4	10	—	6 5/8	21 3/4
135	12 5/16	17 1/2	28 1/4	16 1/4	30 1/2	17 1/2	3	1 3/16	1 3/16	1/4 x 1/8	1 11/16	1 11/16	3/8 x 3/16	25 13/16	28 15/16	18	28 9/16	34 5/16	23 3/8	11	—	7 1/4	23 3/4
150	13 11/16	19	33 3/8	19 1/4	33 3/8	19 1/4	3 1/2	1 7/16	1 7/16	3/8 x 3/16	1 11/16	1 11/16	3/8 x 3/16	28 5/8	32 3/16	20	31 11/16	37 7/16	25 1/4	11 15/16	—	8	25 5/8
165	15 1/16	20 1/2	35 3/4	20 3/8	36 1/8	20 5/8	3 1/2	1 7/16	1 7/16	3/8 x 3/16	1 15/16	1 15/16	1/2 x 1/4	31 3/16	35 3/8	22	34 9/16	40 3/8	27	13 1/8	—	8 5/8	28
182	16 5/8	22 1/2	39	22 1/4	40	22 7/8	4	1 11/16	1 11/16	3/8 x 3/16	2 3/16	2 3/16	1/2 x 1/4	34 1/2	38 11/16	23 15/16	38 1/8	44 1/8	29 3/8	14 1/2	—	9 5/8	31 1/4
200	18 1/4	25	41 7/8	23 3/4	42 7/8	24 1/4	4	1 11/16	1 11/16	3/8 x 3/16	2 3/16	2 3/16	1/2 x 1/4	34 1/4	42 1/4	26 1/16	38 1/4	47 5/8	31 7/16	15 15/16	—	10 7/8	34 1/8
222	20 3/8	27 1/4	45 3/8	25 3/4	46 5/8	26 5/8	4 1/2	1 15/16	1 15/16	1/2 x 1/4	2 7/16	2 7/16	5/8 x 5/16	41 5/8	47	29	40 7/8	52 1/2	34 1/2	17 1/4	—	11 1/8	36 3/4
245	22 3/8	29 3/4	50 1/2	28 5/8	51 1/8	29 1/8	5	2 3/16	2 3/16	1/2 x 1/4	2 7/16	2 7/16	5/8 x 5/16	45 3/8	51 3/4	32	44 7/8	57 7/16	37 5/8	19	—	11 1/8	40 1/4
270	24 3/4	33	54	30 3/8	54 5/8	30 7/8	5	2 3/16	2 3/16	1/2 x 1/4	2 11/16	2 11/16	5/8 x 5/16	50	56 15/16	35 1/8	49 1/2	62 7/16	40 5/8	20 3/4	—	13 1/8	43 3/4

Tolerance ± 1/8
 Not to be used for construction.
 Certified drawings available upon request.



PENNBARRY™

1401 North Plano Road, Richardson, TX 75081
 Ph: 972.234.3202 Fax: 972.497.0468
 www.PennBarry.com

Submittal Sheet

VCR

BI & AF

Arrangement 3, DWDI, Class I & II

This drawing illustrates our understanding of order requirements. When approved, it represents details for fabrication, as such, PennBarry will not be responsible for revisions in the field or other changes after release for fabrication. Published and protected by PennBarry, Richardson, TX. All rights reserved. May not be reproduced partially or in full without permission from the publisher. No rights conveyed to manufacture partially or in full, use or sell either the method of construction represented or any invention in any way related thereto.

VCR

BI & AF - Arrangement 3, DWDI, Class I & II cont.

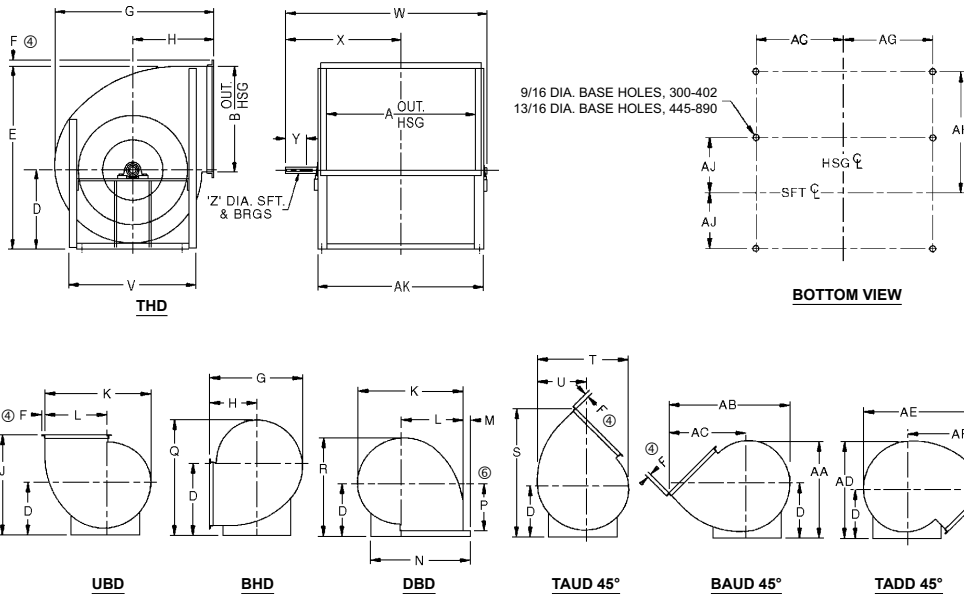

Notes

1. CW rotation shown; CCW rotation similar but opposite.
2. AF available in sizes 182 through 890.
3. BI available in sizes 122 through 890.
4. Discharge angles standard on sizes 402 thru 890 only. (Hole punching optional on all sizes.)
5. On specific sales orders, see Fan Data Schedule for performance and accessory information.
6. On DBD, discharge is extended to base.
7. *Shaft smaller on BI.

Dimensional Data

Size	A	B	"D" Centerline of Fan							E	F	G	H	J	K	L	M	N	P	Q	R	S	T
			THD	UBD	BHD	DBD	TAUD	BAUD	TADD														
300	42 7/16	31 13/16	24	27	35	24	26	29 1/2	26	55 3/4	1 1/2	49 1/4	23 7/16	50 7/16	54 1/2	31 3/4	2 1/2	54 1/4	24	57 3/4	49 13/16	65 1/8	48 3/4
330	47 3/16	34 15/16	27	30	38	26 1/2	28 1/2	32 1/2	28	61 7/8	1 1/2	54 3/16	25 13/16	55 13/16	59 7/8	34 7/8	2 1/2	59 3/8	26 1/2	63	54 7/8	71 3/8	53 1/2
365	51 3/4	38 11/16	29 1/2	33 1/2	41	29	31 1/2	35 1/2	29 1/2	68 1/8	1 1/2	60 1/8	28 5/8	62 1/8	66 5/16	38 5/8	2 1/2	64 5/8	29	68 11/16	60 1/2	79 1/8	59 1/2
402	57 1/2	42 9/16	32 1/2	36 1/2	45 1/2	32	35	39 1/2	32	75	2	66 11/16	32	68 1/2	73 1/16	42 1/2	2 1/2	70 1/2	32	76 1/16	66 11/16	87 3/8	65 1/2
445	63 1/4	47 3/16	35 1/2	40	50	34	38	43	36	82 9/16	2	72 1/8	33 3/4	73 3/4	80 7/8	47 1/16	3 1/2	79 5/16	34	83 13/16	72 3/8	95 1/4	72 3/8
490	70	51 13/16	39	44	55	37 1/2	42	47	38	90 3/4	2	79 11/16	37 1/2	81 1/2	88 7/8	51 3/4	3 1/2	86 1/4	37 1/2	92 1/8	79 11/16	105 1/8	79 5/8
542	77	57 7/16	43 1/2	49	60	40 1/2	46	52	42	100 7/8	2	87 1/4	40 1/2	89 1/2	98 9/16	57 3/8	3 1/2	94 7/8	40 1/2	101 3/16	87 1/4	115 1/4	88 1/4
600	85 1/8	63 7/16	48	54	66 1/2	44 1/2	51	57	45	111 3/8	2	96 3/16	44 1/2	98 1/2	108 7/8	63 3/8	3 1/2	103 7/8	44 1/2	112	96 3/16	127 3/8	97 1/2
660	94 1/4	69 13/16	52 1/2	59	73 1/4	49	55 3/4	63	49 1/2	122 1/4	2 1/2	105 3/4	49	108	119 5/8	69 3/4	5	114 3/4	49	123 1/8	105 3/4	139 3/4	107
730	104	77 1/4	57	64 1/4	80 3/4	57 3/4	61 3/4	69 1/2	54 1/4	134 1/8	2 1/2	120 5/8	57 3/4	122 1/4	132 1/2	77 1/8	5	126 1/8	57 3/4	136 1/8	120 5/8	157 1/8	118 5/8
807	114 11/16	85 7/16	63	72	89	63 3/4	67 1/2	76 1/2	59 1/2	148 5/16	2 1/2	133 5/16	63 3/4	135 3/4	146 9/16	85 5/16	5	138 1/8	63 3/4	150 1/4	133 5/16	172 7/8	130 7/8
890	126 3/8	94 1/4	69 1/4	78 1/4	97 3/4	70 1/2	73 3/4	85	65 1/2	163 3/8	2 1/2	147 1/8	70 1/2	148 3/4	161 5/8	94 1/8	5	152 3/8	70 1/2	165 1/4	147 1/8	190 1/4	144 5/8

Size	U	V	CLASS I		CLASS II		Y	Z - CLASS I			Z - CLASS II			AA	AB	AC	AD	AE	AF	AG	AH	AJ	AK
			W	X	W	X		SFT	DR. EXT.	KWY	SFT	DR. EXT.	KWY										
300	27 1/2	40	59 7/8	33 3/4	60	33 3/4	5 1/2	2 7/16	2 7/16	5/8 x 5/16	2 11/16	2 11/16	5/8 x 5/16	50 3/4	63 5/16	39	53 1/2	69 5/8	45 1/4	22 5/8	33 1/8	16 7/8	47 7/16
330	30 1/4	44	63 5/8	35 5/8	63 5/8	35 5/8	5 1/2	2 7/16	2 7/16	5/8 x 5/16	2 15/16	2 7/16	5/8 x 5/16	55 3/4	69 9/16	42 7/8	58 1/4	75 5/8	49	25	36 1/4	18 7/8	52 3/16
365	33 1/2	47	68 5/8	38 1/8	68 5/8	38 1/8	5 1/2	2 11/16	2 11/16	5/8 x 5/16	3 7/16	2 7/16	5/8 x 5/16	61 1/2	77 1/4	47 5/8	63	83 1/8	53 1/2	27 1/4	40	20 3/8	56 3/4
402	37	51	74 7/8	41 5/8	74 3/8	41 1/4	6	2 15/16	2 15/16	3/4 x 3/8	3 7/16	2 7/16	5/8 x 5/16	68	85 3/8	52 3/4	69	92 1/4	59 5/8	30 1/8	43 7/8	22 3/8	62 1/2
445	40 7/8	57 1/2	80	43 7/8	80 3/4	44 3/8	6	3 3/16	2 3/16	1/2 x 1/4	3 15/16	2 11/16	5/8 x 5/16	74 1/2	93 3/8	57 1/4	76 7/8	100 3/4	64 5/8	33 1/2	48 15/16	23 5/8	70 1/4
490	44 7/8	62	88 3/8	48 3/4	91 1/2	50 5/8	7	3 7/16	2 7/16	5/8 x 5/16	3 15/16	3 7/16	7/8 x 7/16	81 3/4	102 7/8	63 1/8	82 7/8	110 3/8	70 5/8	36 7/8	53 5/8	25 7/8	77
542	49 3/4	68	96 1/2	52 3/4	98 1/2	54 1/8	7	3 15/16	2 11/16	5/8 x 5/16	4 7/16	3 7/16	7/8 x 7/16	90 1/2	113 1/4	69 1/4	91 3/4	121	77	40 3/8	59 1/4	28 7/8	84
600	55	74	105 5/8	57 7/8	107 5/8	59 1/4	8	3 15/16	2 11/16	5/8 x 5/16	4 15/16	3 7/16	7/8 x 7/16	99 1/2	125	76 3/8	100	133 1/8	84 1/2	44 1/2	65 1/4	31 7/8	92 1/8
660	60 1/2	80	115 1/8	62 3/4	116 3/4	63 3/4	8	4 7/16	2 15/16	3/4 x 3/8	4 15/16	3 7/16	7/8 x 7/16	109 1/2	137 3/8	84	110	146 1/8	92 3/4	49 3/4	72 3/8	33 1/8	104 1/4
730	67	88	127 1/2	69 5/8	127 1/2	69 5/8	9	4 15/16	3 7/16	7/8 x 7/16	5 15/16	3 15/16	1 x 1/2	121 1/8	154 1/2	95 3/8	121 1/4	161 1/8	102	54 5/8	79 3/4	37 1/8	114
807	73 3/4	95 1/2	138 1/4	75	139 7/8	75 5/8	9	5 15/16	3 15/16	1 x 1/2	6 7/16	4 7/16	1 x 1/2	133 5/8	170 5/8	105 3/8	133 1/4	176 7/8	111 5/8	60	87 15/16	40 7/8	124 11/16
890	81 5/8	106 1/2	153	82 1/2	153	82 1/2	9	6 7/16	4 7/16	1 x 1/2	*6 11/16	4 7/16	1 x 1/2	148	188 3/8	116 1/2	147 1/8	198 7/8	126 7/8	65 13/16	96 3/4	46 3/8	136 3/8

Tolerance ± 1/8

Not to be used for construction.

Certified drawings available upon request.



PENNBARRY™

1401 North Plano Road, Richardson, TX 75081
Ph: 972.234.3202 Fax: 972.497.0468
www.PennBarry.com

Submittal Sheet

VCR

BI & AF

Arrangement 3, DWDI, Class I & II

This drawing illustrates our understanding of order requirements. When approved, it represents details for fabrication, as such, PennBarry will not be responsible for revisions in the field or other changes after release for fabrication. Published and protected by PennBarry, Richardson, TX. All rights reserved. May not be reproduced partially or in full without permission from the publisher. No rights conveyed to manufacture partially or in full, use or sell either the method of construction represented or any invention in any way related thereto.

Form ES-VCR-3, DWDI, CI&II cont.

Revised March 2005